

Department of Engineering
Tim Bryan, P.E., County Engineer

3137 South Liberty Street, Canton, MS 39046
Office (601) 790-2525 FAX (601) 859-3430

MEMORANDUM

September 17, 2021

To: Sheila Jones, Supervisor, District I
Trey Baxter, Supervisor, District II
Gerald Steen, Supervisor, District III
Karl Banks, Supervisor, District IV
Paul Griffin, Supervisor, District V

From: Tim Bryan, P.E., PTOE
County Engineer

Re: Atmos Energy Utility Permit
County Road Name, Yandell Road

The Engineering Department recommends approval of permit application for Atmos Energy Corporation to install approximately 5,050 feet of 4-inch HDPE natural gas main along Yandell Road in County ROW to provide natural gas service to Expedition Pointe subdivision.

SHEILA JONES
District One

TREY BAXTER
District Two

GERALD STEEN
District Three

KARL BANKS
District Four

PAUL GRIFFIN
District Five



PERMIT APPLICATION FOR THE CONSTRUCTION OR ADJUSTMENT OF A UTILITY WITHIN COUNTY ROAD RIGHT-OF-WAY

Utility Information: Utility Name: _____

Address: _____ City/State/Zip: _____

Contact Person: _____ Contact's Phone: _____

Project Information: County Road Name: _____

(If located within more than one road right-of-way, use Appendix 1 for additional descriptions)

Beginning Location: _____ Ending Location: _____

Length of Project: _____ Section: _____ Township: _____ Range: _____

Description of Work: _____

Check Box if Appendix 1 is to be included as a part of this Application

Whereas the above stated Utility makes application to the **Madison County Board of Supervisors** for a Construction Permit. Attached hereto are drawings and plans for the construction of the above facilities located within Madison County owned public rights-of-way. Once stamped by the Madison County Engineering Department, these plans shall not be changed or altered without written approval of the County Engineer, or his representative. A copy of the approved permit and plans shall be on-site at all times during construction.

The Applicant Utility shall comply with all policies, procedures and construction practices as outlined in *A Policy for The Accommodation of Utility Facilities within the Right-of-Way of all Public County Roads* (hereinafter referred to as the "Policy"), as adopted on November 1, 2005, by the **Madison County Board of Supervisors**, and which is hereby made a part of this Application Agreement.

If facilities are to be located within the Rights-of-Way of the County-Federal or State Aid System, Applicant Utility also agrees to comply with applicable provisions of *S.O.P. No. SA II-2-8, Accommodation of Utilities on Rights-of-Way*, issued by the State Aid Engineer and dated July 1, 2005.

The Applicant Utility understands and agrees that, except as herein granted, no right, title, claim, or easement to said road right-of-way is granted by the issuance of this permit. If this Utility is listed in the general provisions of the Policy, it will be adjusted to comply with same without cost to the County, unless the variance from the Policy has been approved by the granting of the Permit pursuant to this Application.

The Applicant Utility further understands that the Utility's engineering, plant, or other personnel will be responsible for the staking and construction supervision of the work set out above and as shown on the attached plans. If work impacts traffic in any way, the appropriate traffic control shall be installed per the *Manual of Uniform Traffic Control Devices*, Latest Edition.

The Applicant Utility understands that the County Engineer, or his representative, may issue a Stop Work Order at any time if it is deemed that site conditions are not suitable for construction or if any of the requirements of this permit are not being met.

Many County Roads have variable Rights-of-Way and/or no Right-of-Way at all and are maintained under a Prescriptive Easement. It is the sole responsibility of the Applicant Utility to verify the existence and limits of public rights-of-way. If none exists, it is the

responsibility of the Applicant Utility to acquire an easement for their Facilities from the applicable property owner(s). Madison County in no way verifies the limits of Right-of-Way as shown on the permit application.

The Applicant Utility shall be responsible for all future maintenance and repair of the facilities installed under this permit. The Applicant Utility shall make future adjustments to, or relocate, the facilities located within road or highway right-of-way when required for road or highway widening or other road or highway construction at no cost to Madison County. The Applicant Utility shall relocate said utilities within sixty (60) days of notification by County by registered mail, return receipt requested, unless otherwise designated by the County Engineer. Further, any maintenance, repair, or construction shall be done in such a manner as to occasion no unreasonable interference with the normal flow and safety to traffic and at the expense of the utility company. When reasonable care has been taken to locate said utility facilities within the right-of-way, the Applicant Utility understands that any damages caused by routine maintenance and construction by County forces shall be borne by the Applicant Utility.

The Applicant Utility further agrees to indemnify and hold Madison County harmless for any and all claims, accidents, damages, liabilities and expenses occasioned wholly, or in part, by any act or omission of applicant, its agents or employees. In case County shall, without fault on its own part, be made a party to any litigation commenced by or against applicant, then applicant shall protect and hold County harmless, and shall pay all costs, expenses and reasonable attorney's fees incurred or paid by County in connection with said litigation.

All underground facilities shall be installed at a depth equal to or greater than 48" below the lowest adjacent grade.

All pipes carrying liquid shall be encased under County maintained roads.

WITNESS the signature of the Applicant this the _____ day of _____, 20_____.

By: Wesley A. McCluse
(Applicant Signature)

Title: _____

Note: *Applicant must be an employee of the Utility named in this application. The Madison County Board of Supervisors will not recognize a Contractor, Subcontractor, Agent, or Consulting Engineer as the Applicant. Utility Company shall be fully responsible for all work performed under this application.*

I, or my authorized representative, have reviewed this application and determined that the drawing, sketches, and plans submitted by the Applicant meet the requirements of *A Policy for The Accommodation of Utility Facilities within the Right-of-Way of all Public County Roads.*

APPROVED

By: **By timothy.bryan at 11:19 am, Sep 29, 2021**

**Tim Bryan, P.E.
County Engineer**

AGREED TO AND APPROVED BY:

Madison County Board President

Date: _____

ENTERED INTO THE MINUTES OF THE BOARD OF SUPERVISORS OF MADISON COUNTY, MISSISSIPPI ON THIS

_____ DAY OF _____, 20_____.

Appendix 1

County Road Name: _____
Beginning Location: _____ Ending Location: _____
Length of Project: _____ Section: _____ Township: _____ Range: _____
Description of Work: _____

County Road Name: _____
Beginning Location: _____ Ending Location: _____
Length of Project: _____ Section: _____ Township: _____ Range: _____
Description of Work: _____

County Road Name: _____
Beginning Location: _____ Ending Location: _____
Length of Project: _____ Section: _____ Township: _____ Range: _____
Description of Work: _____

County Road Name: _____
Beginning Location: _____ Ending Location: _____
Length of Project: _____ Section: _____ Township: _____ Range: _____
Description of Work: _____

County Road Name: _____
Beginning Location: _____ Ending Location: _____
Length of Project: _____ Section: _____ Township: _____ Range: _____
Description of Work: _____

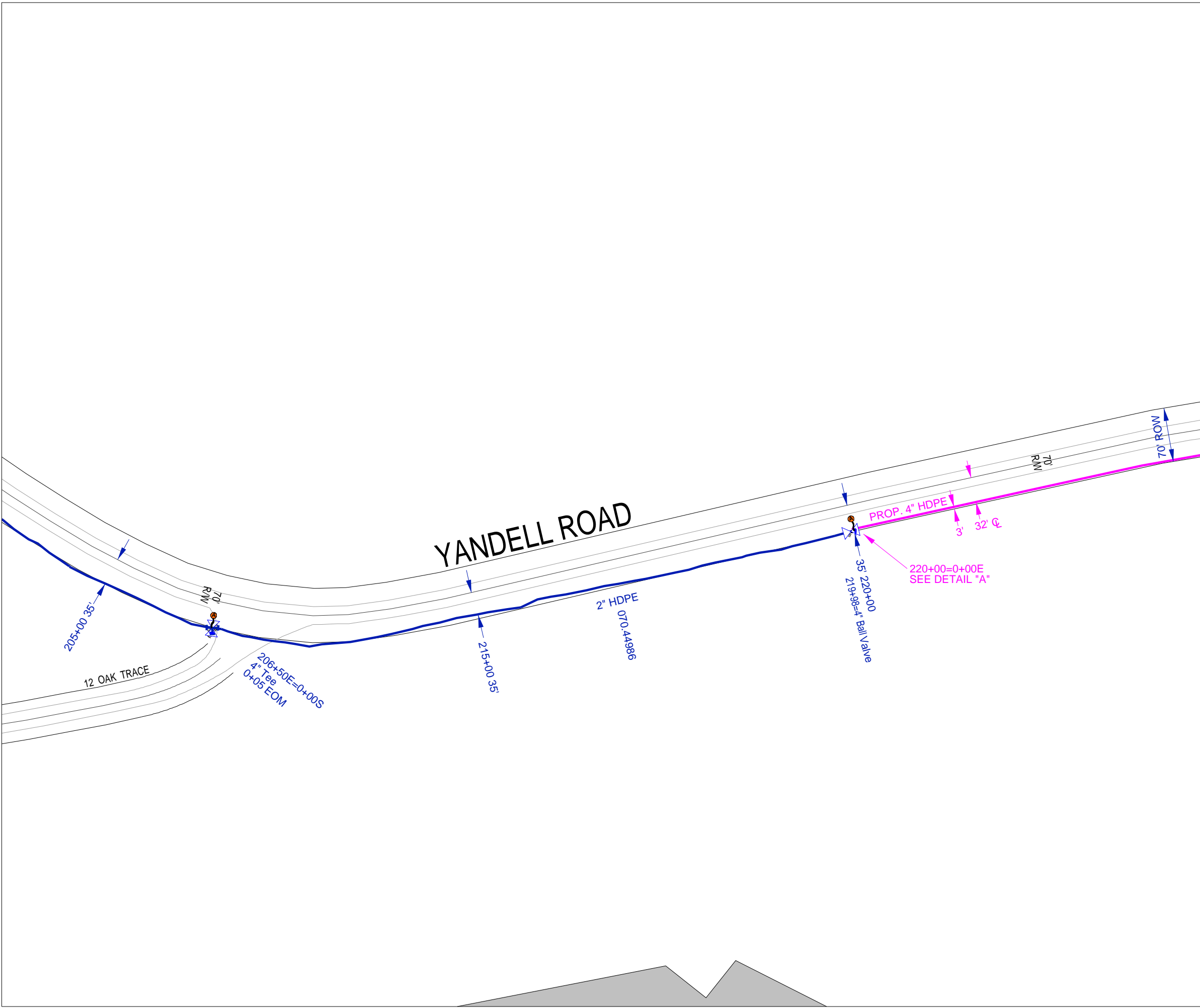

Legend

- Main.Existing Intermediate Pressure Route
- Main.Proposed Intermediate Pressure Route
- Cap.Existing Location
- Tee.Existing Location
- Valve.Existing Non Critical Location - Open
- ABC DEF Valve.Station Plus Annotation - Existing
- CP Anode.Existing Location
- Foreign Pipe.Existing Route
- Line Marker.Ball Location
- Main And Service Dimension.Large Arrow - Existing
- Main And Service Dimension.Large Arrow - Proposed
- Main And Service Dimension.Large Arrow2 - Existing
- ABC DEF Main And Service Dimension.Large Existing Anno
- Main And Service Dimension.Large Existing Route
- ABC DEF Main And Service Dimension.Large Proposed Anno
- Main And Service Dimension.Large Proposed Route
- Main And Service Dimension.Small Arrow - Proposed
- ABC DEF Main And Service Dimension.Small Proposed Anno
- Main And Service Dimension.Small Proposed Route

GAS CONSTRUCTION PRINT

PROJECT NO. _____

SHEET 1 OF 5

PROJECT McCleese, Wes DATE 09/17/2021

MANAGER _____

PHONE _____ MAP # _____

© 2009 Atmos Energy

Maps, drawings and electronic data (products) are created for the internal purposes of Atmos Energy with an implication of suitability or fitness for the internal use of the recipient. Atmos Energy will make good faith efforts to provide products that are free from error, but does not warrant the accuracy or quality of such products. The locations shown are approximations and are not intended to show exact locations. Products provided to other parties by Atmos Energy are for the internal use of the recipient, and the recipient agrees not to duplicate or distribute the products or any portion of the products to third parties without the prior written permission of Atmos Energy. The recipient further agrees to hold harmless and indemnify Atmos Energy against all claims, costs, expenses and damages resulting from or predicated upon strict liability for personal injuries, death or property damage, on account of any defects in the property provided hereunder.

PROJECT NAME 070.5073.GR.4PE, YANDELL.EXT2

CUSTOMER _____

ADDRESS _____

LOCATION _____

YANDELL ROAD

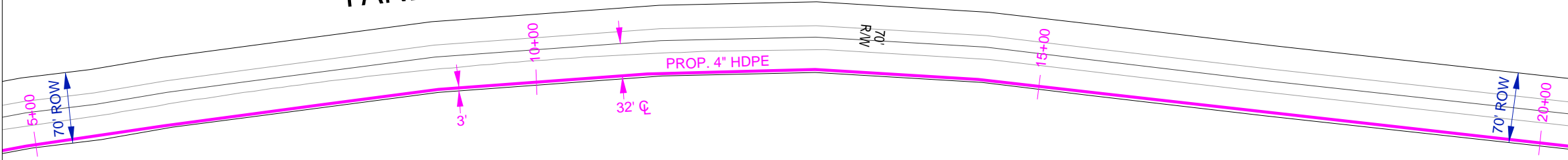

Legend

- Main.Existing Intermediate Pressure Route
- Main.Proposed Intermediate Pressure Route
- D Cap.Existing Location
- X Valve.Existing Non Critical Location - Open
- Abc Def Valve.Station Plus Annotation - Existing
- ⚡ CP Anode.Existing Location
- Foreign Pipe.Existing Route
- ⊙ Line Marker.Ball Location
- ▶ Main And Service Dimension.Large Arrow - Existing
- ▶ Main And Service Dimension.Large Arrow - Proposed
- ▶ Main And Service Dimension.Large Arrow2 - Existing
- Abc Def Main And Service Dimension.Large Existing Anno
- Main And Service Dimension.Large Existing Route
- Abc Def Main And Service Dimension.Large Proposed Anno
- Main And Service Dimension.Large Proposed Route
- ▶ Main And Service Dimension.Small Arrow - Proposed
- Abc Def Main And Service Dimension.Small Proposed Anno
- Main And Service Dimension.Small Proposed Route



GAS CONSTRUCTION PRINT

PROJECT NO. _____

SHEET 2 OF 5

DATE 09/17/2021

PROJECT McCleese, Wes

MANAGER _____

PHONE _____ MAP # _____

© 2009 Atmos Energy

Maps, drawings and electronic data (products) are created for the internal purposes of Atmos Energy with an implication of suitability or fitness for the internal use of the recipient. Atmos Energy will make good faith efforts to provide products that are free from error, but does not warrant the accuracy or quality of such products. The locations shown are approximations and are not intended to show exact locations. Products provided to other parties by Atmos Energy are for the internal use of the recipient, and the recipient agrees not to duplicate or distribute the products or any portion of the products to third parties without the prior written permission of Atmos Energy. The recipient further agrees to hold harmless and indemnify Atmos Energy against all claims, costs, expenses and damages resulting from or predicated upon strict liability for personal injuries, death or property damage, on account of any defects in the property provided hereunder.













PROJECT NAME 070.5073.GR.4PE,YANDELL.EXT2

CUSTOMER _____

ADDRESS _____

LOCATION _____

Legend

-  Main.Existing Intermediate Pressure Route
-  Main.Proposed Intermediate Pressure Route
-  Foreign Pipe.Existing Route
-  Main And Service Dimension.Large Arrow - Existing
-  Main And Service Dimension.Large Arrow2 - Existing
-  *Abc Def* Main And Service Dimension.Large Existing Anno
-  Main And Service Dimension.Large Existing Route
-  *Abc Def* Main And Service Dimension.Large Proposed Anno
-  Main And Service Dimension.Large Proposed Route
-  Main And Service Dimension.Small Arrow - Proposed
-  *Abc Def* Main And Service Dimension.Small Proposed Anno
-  Main And Service Dimension.Small Proposed Route

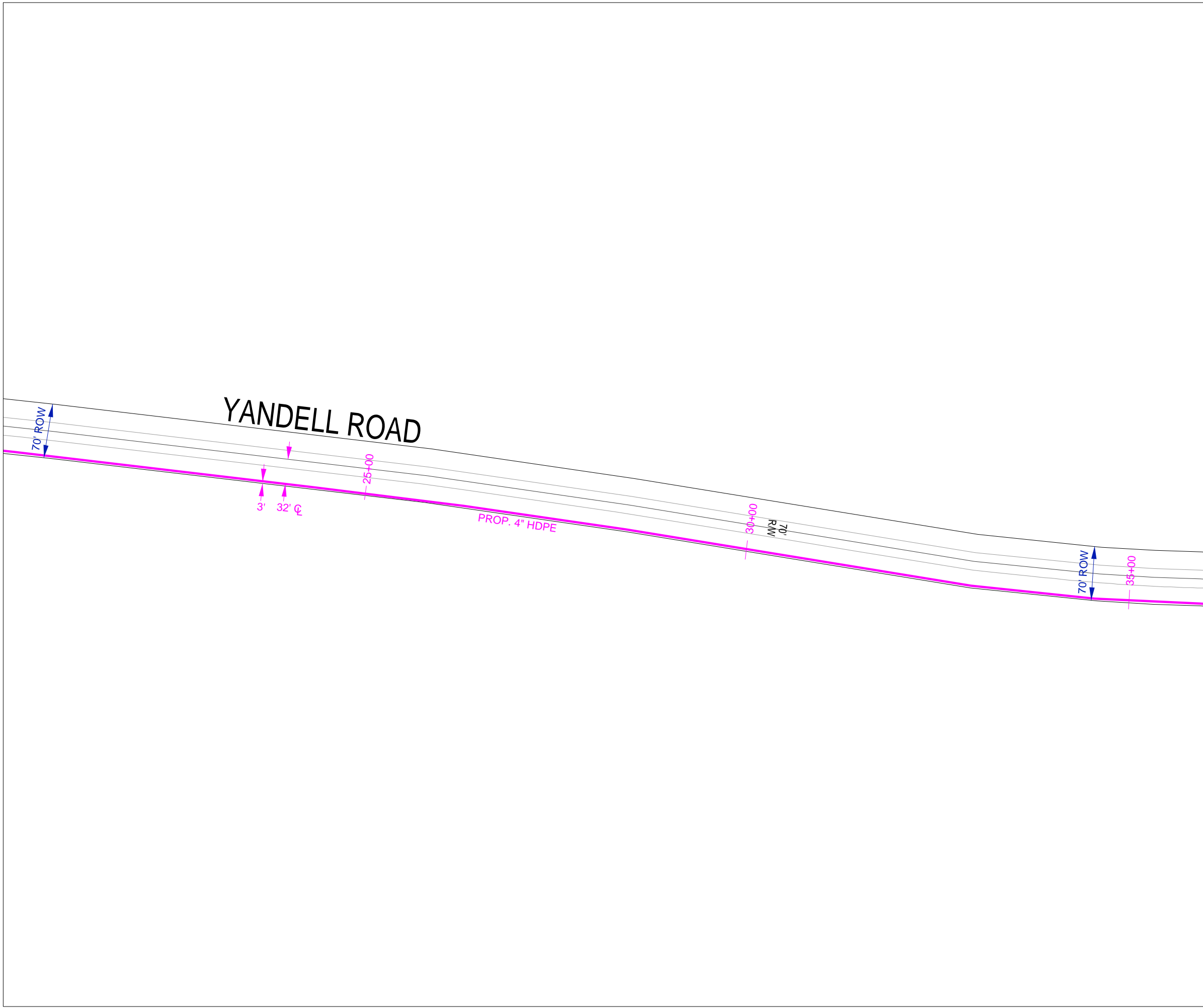

GAS CONSTRUCTION PRINT

PROJECT NO. _____

SHEET 3 OF 5

PROJECT McCleese, Wes DATE 09/17/2021

MANAGER _____

PHONE _____ MAP # _____

© 2009 Atmos Energy

Maps, drawings and electronic data (products) are created for the internal purposes of Atmos Energy with on implication of suitability or fitness for the internal use of the recipient. Atmos Energy will make good faith efforts to provide products that are free from error, but does not warrant the accuracy or quality of such products. The locations shown are approximations and are not intended to show exact locations. Products provided to other parties by Atmos Energy are for the internal use of the recipient, and the recipient agrees not to duplicate or distribute the products or any portion of the products to third parties without the prior written permission of Atmos Energy. The recipient further agrees to hold harmless and indemnify Atmos Energy against all claims, costs, expenses and damages resulting from or predicated upon strict liability for personal injuries, death or property damage, on account of any defects in the property provided hereunder.











PROJECT NAME 070.5073.GR.4PE,YANDELL.EXT2

CUSTOMER _____

ADDRESS _____

LOCATION _____

Legend

-  Main.Existing Intermediate Pressure Route
-  Main.Proposed Intermediate Pressure Route
-  Valve.Proposed Non Critical Location - Open
-  Foreign Pipe.Existing Route
- Abc Def Main And Service Dimension.Large Anno
-  Main And Service Dimension.Large Arrow - Existing
-  Main And Service Dimension.Large Arrow - Proposed
-  Main And Service Dimension.Large Arrow2 - Existing
- Abc Def Main And Service Dimension.Large Existing Anno
-  Main And Service Dimension.Large Existing Route
- Abc Def Main And Service Dimension.Large Proposed Anno
-  Main And Service Dimension.Large Proposed Route
-  Main And Service Dimension.Small Arrow - Proposed
- Abc Def Main And Service Dimension.Small Proposed Anno
-  Main And Service Dimension.Small Proposed Route

YANDELL ROAD

YANDELL ROAD

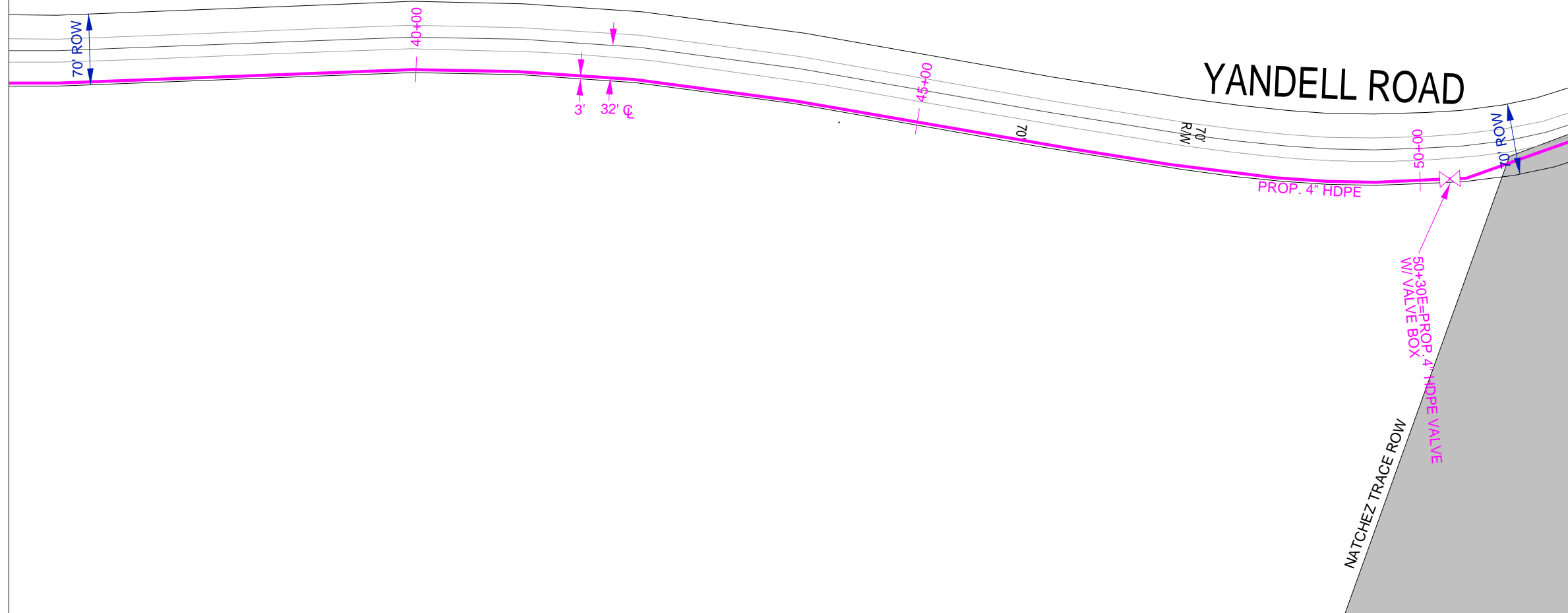

GAS CONSTRUCTION PRINT

PROJECT NO. _____



SHEET 4 OF 5

PROJECT McCleese, Wes
MANAGER _____

DATE 09/17/2021

PHONE _____

MAP # _____

© 2009 Atmos Energy

Maps, drawings and electronic data (products) are created for the internal purposes of Atmos Energy with an implication of suitability or fitness for the internal use of the recipient. Atmos Energy will make good faith efforts to provide products that are free from error, but does not warrant the accuracy or quality of such products. The locations shown are approximations and are not intended to show exact locations. Products provided to other parties by Atmos Energy are for the internal use of the recipient, and the recipient agrees not to duplicate or distribute the products or any portion of the products to third parties without the prior written permission of Atmos Energy. The recipient further agrees to hold harmless and indemnify Atmos Energy against all claims, costs, expenses and damages resulting from or predicated upon strict liability for personal injuries, death or property damage, on account of any defects in the property provided hereunder.

PROJECT NAME 070.5073.GR.4PE, YANDELL.EXT2

CUSTOMER _____

ADDRESS _____

LOCATION _____

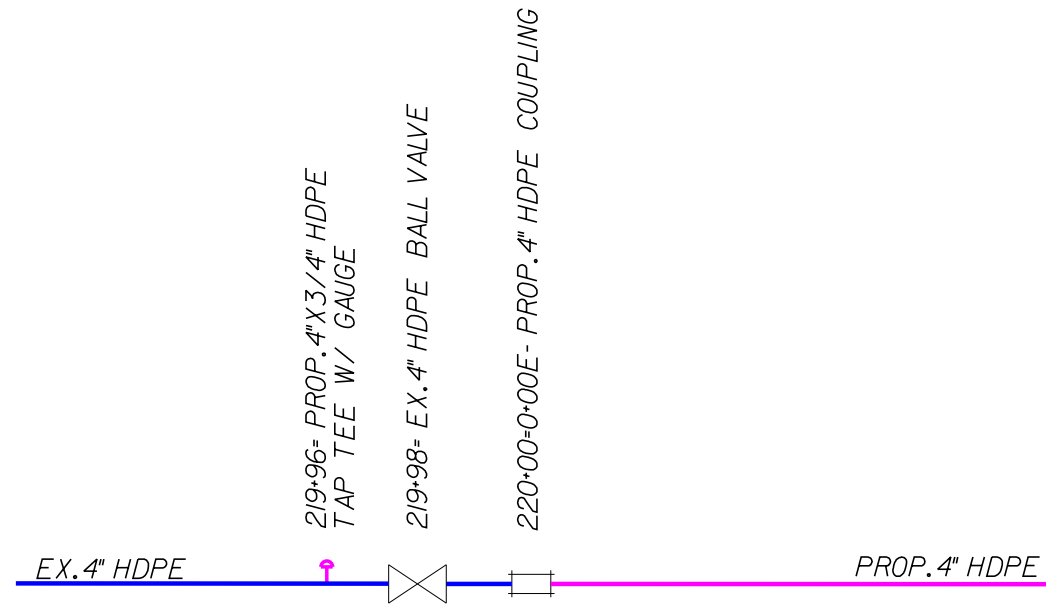
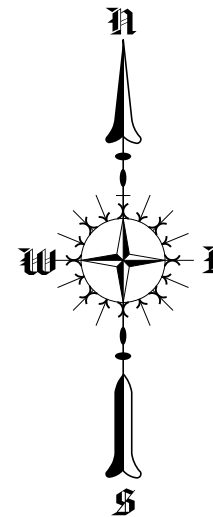

DETAIL "A"
N. T. S.



Know what's below.
Call before you dig.



PROJECT #:		
CANTON: INSTALL 4" HDPE TO SERVE EXPEDITION POINT		
CANTON, MADISON COUNTY, MISSISSIPPI ATMOS ENERGY CORPORATION		
DRAWN BY: WES McCLEESE	DATE: 8/23/2021	T.N. *
CHECKED BY: GREG SPROW	SCALE: N.T.S.	SHEET 5 OF 5